

2

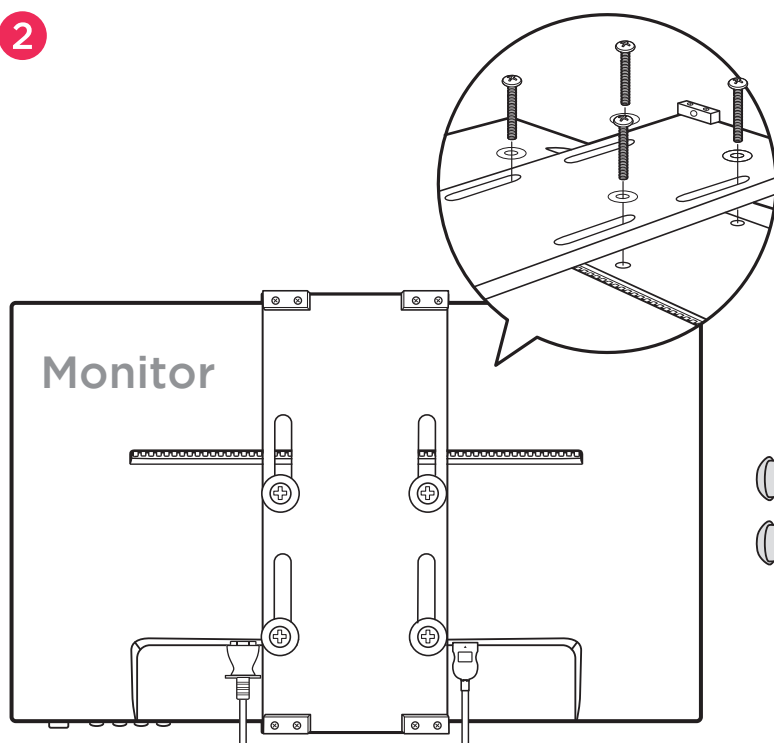

5

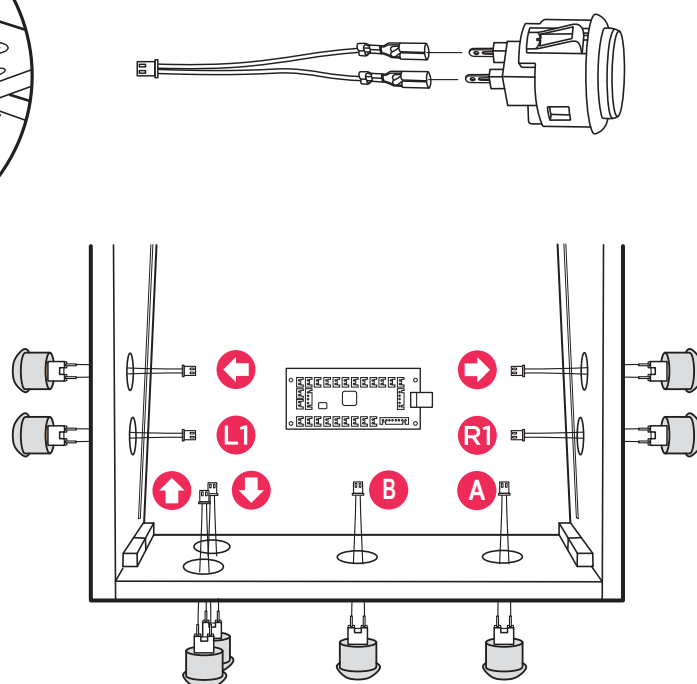

3

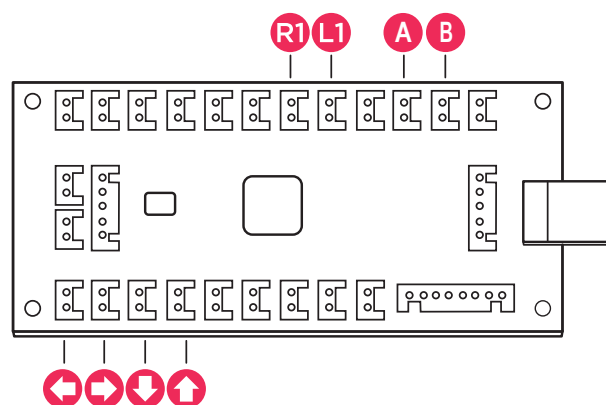
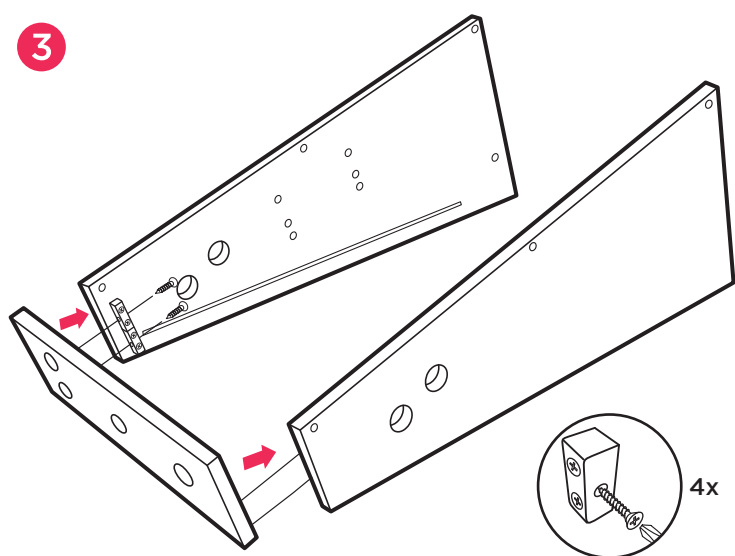

4

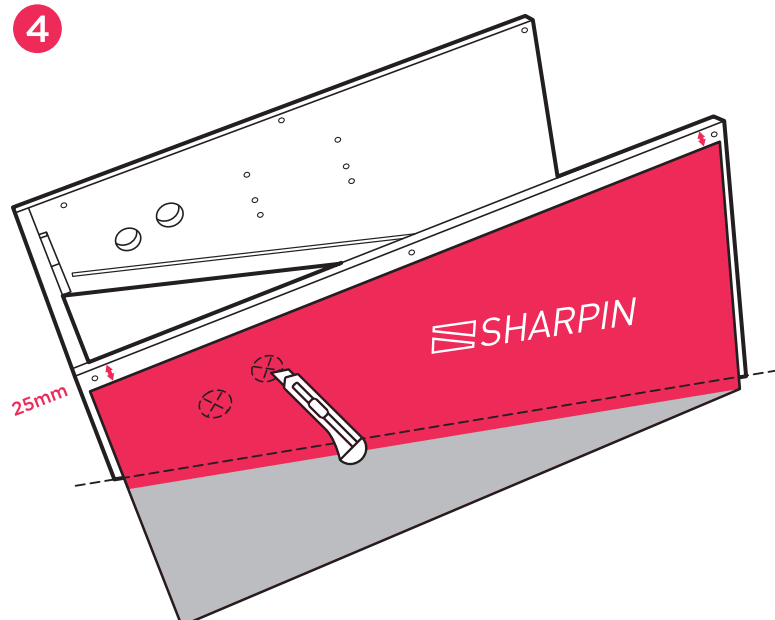

## Nintendo Switch ONLY

On the Switch console menu:  
Settings -> Handle and Sensor ->  
Wired Connection for Professional Handle  
to On.

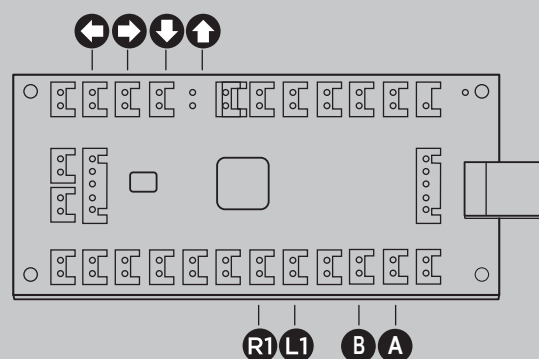

**6** Turn it upside down

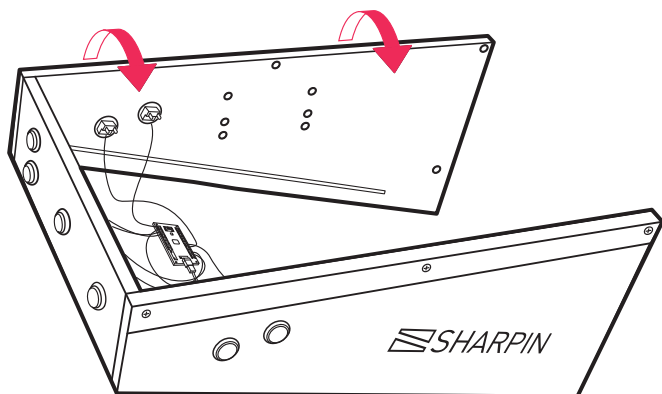

**7** Mount the monitor

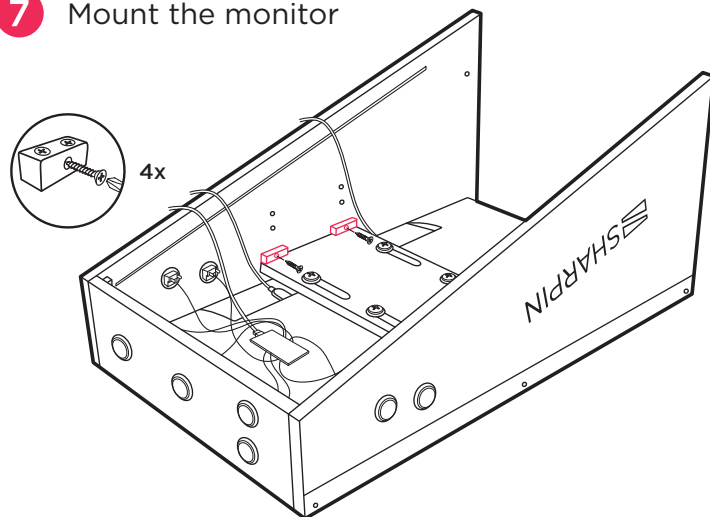

**8**

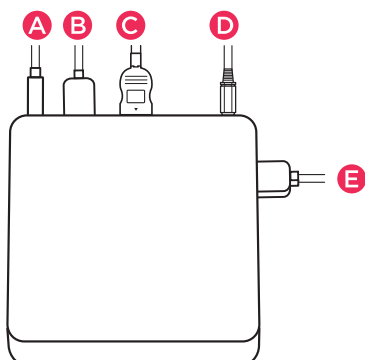
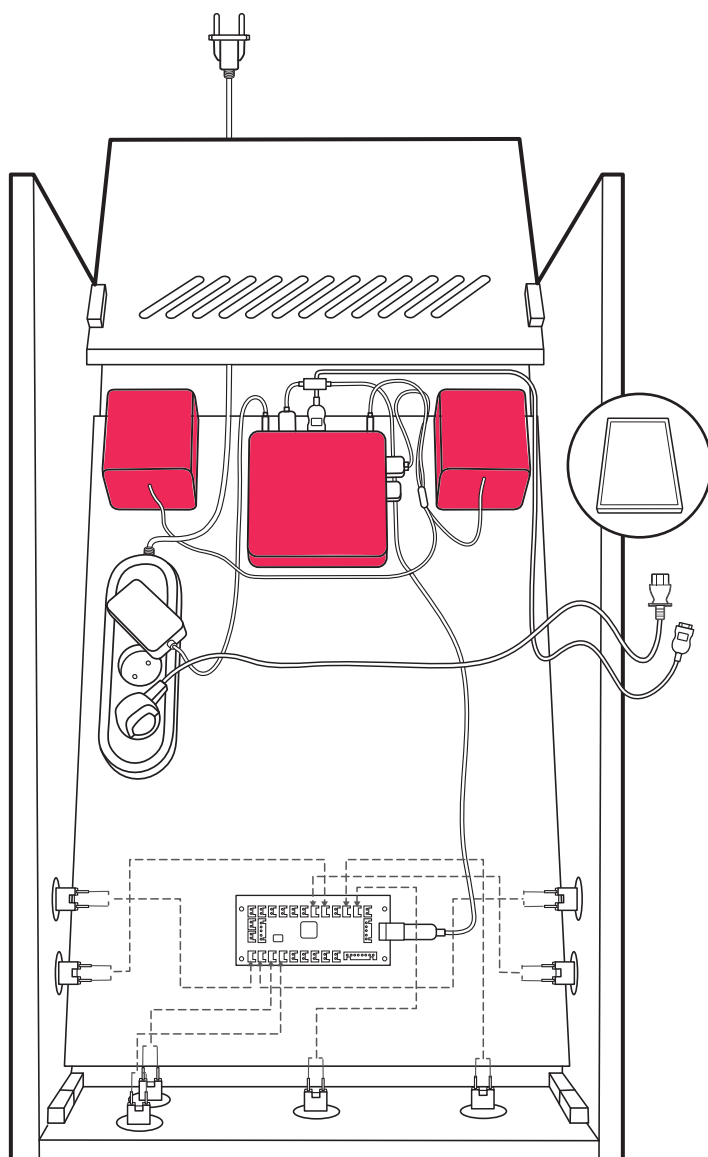
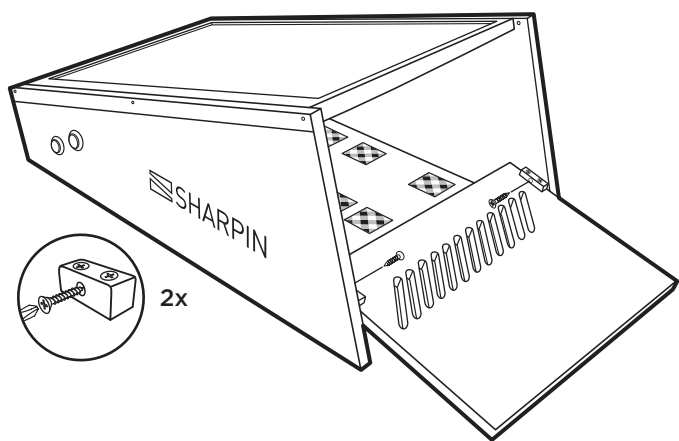
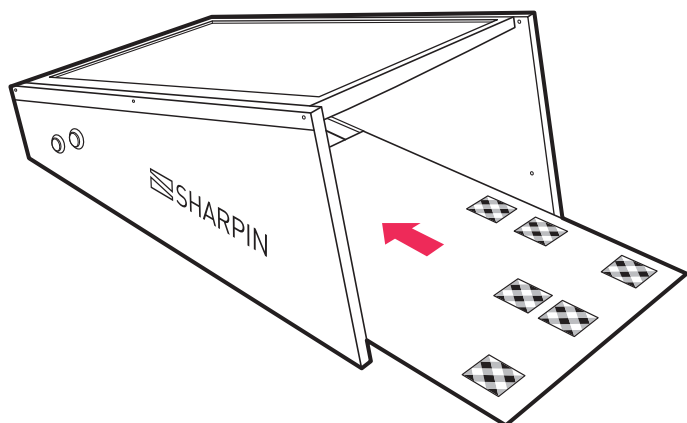

- A. Power
- B. Button Controller
- C. Screen
- D. Speaker
- E. Speaker Power

**Don't** insert the SD card.



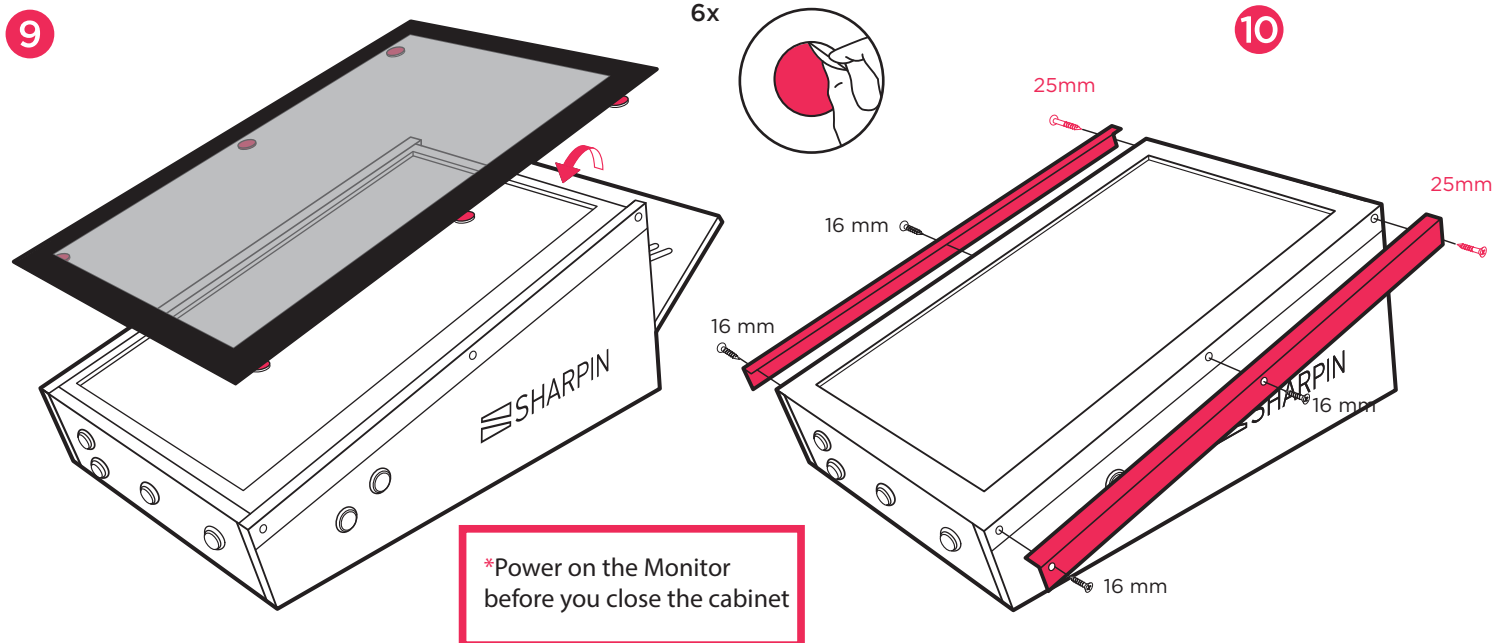

## Backglass Mount (only for Sharpin Ultra MAX)

- 1 Install and open the Sharpin Sender App on the Android Box [digital-pinball.com/score](http://digital-pinball.com/score)
- 2 Open the Sharpin Score app on the tablet. It is already installed
- 3 Login on both devices and start playing.

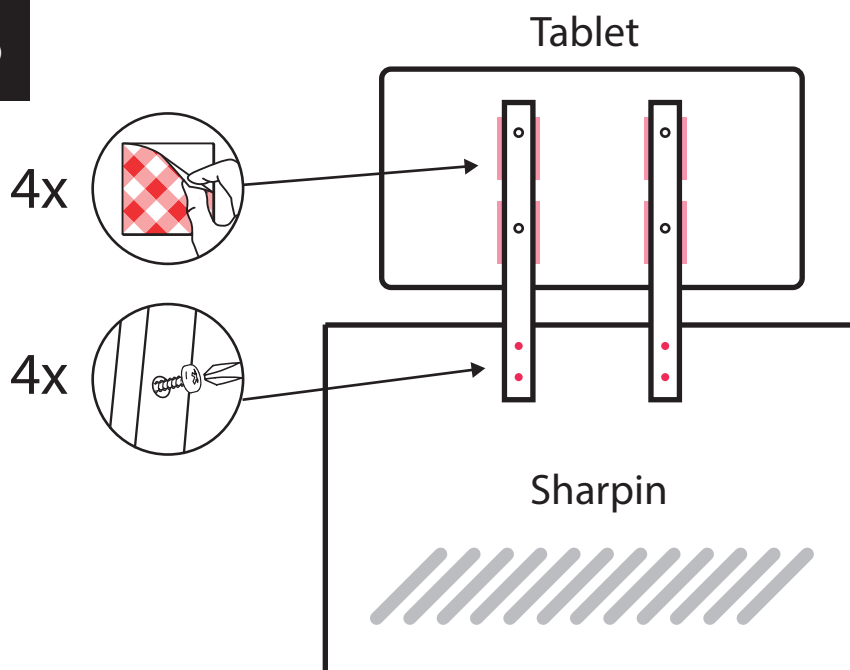

## Digital to Analog Audio Converter (only for TX6 Android Box)

